



THE MARCUS WHITMAN

HOTEL & CONFERENCE CENTER

ROOM	DIMENSIONS	SQ. FT.	THEATRE	CLASSROOM	BANQUET
Explorer Ballroom	52' X 103'3"	5360	460	378	400
Lewis	52' X 34'6"	1790	140	110	120
Clark	52' X 34'3"	1780	140	110	120
Sacajawea	52' X 34'6"	1790	140	110	120
Renaissance Ballroom	28'6" X 68'2"	1947	162	108	100
Empire Ballroom	28'6" X 44'8"	1293	96	72	60
Native American Rooms	50'9" X 20'0"	963	105	53	—
Cayuse	17'6" X 20'0"	368	35	25	—
Nez Perce	17' X 20'0"	315	25	16	—
Umatilla	17' X 20'0"	280	25	12	—
Walla Walla Boardroom	19'10" X 25'1"		Up to 14 around the Conference Table		



THE MARCUS WHITMAN

FIRST FLOOR & CONFERENCE CENTER

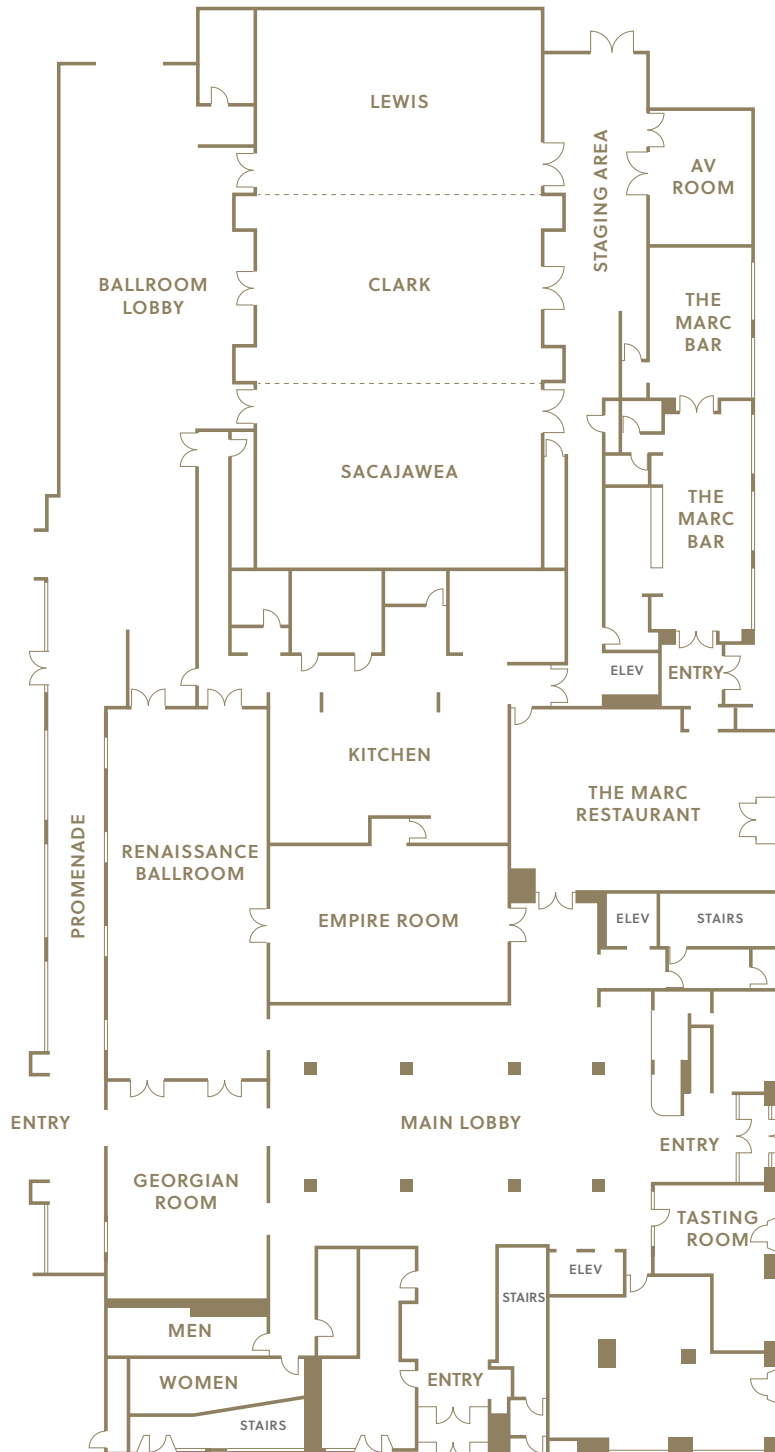



THE MARCUS WHITMAN

SECOND FLOOR

